

**ROXEL**

Inspire  
Your Soul

**RGM350**  
Head-mounted e-sports wired headset  
User Manual

**Dear user**

Thank you for purchasing RGM350 foldable stereo wireless headphones.

**ROXEL:**  
@2019 ROXEL, All rights reserved by ROXEL Limited registered in United Kingdom. The logo "ROXEL" is a trademark of ROXEL Limited.

**Address**  
Roxel Limited  
Unit 11a Lakes Industrial Park  
Lower Chapel Hill  
Braintree  
Essex  
CM7 3RU

- ✉ support@roxel.co.uk
- 🌐 www.roxel.co.uk
- 📘 facebook.com/RoxelUK
- 🐦 twitter.com/roxeluk
- 📷 instagram.com/roxel\_uk

1

**Introduction**

Thank you for purchasing the model RGM350 Head-mounted e-sports wired headset. Pls read this manual before use.

**Accessories List**

- 1X Headphone
- 1X User Manual
- 1X 3.5mm Connector



2

**Overview Of Headset**

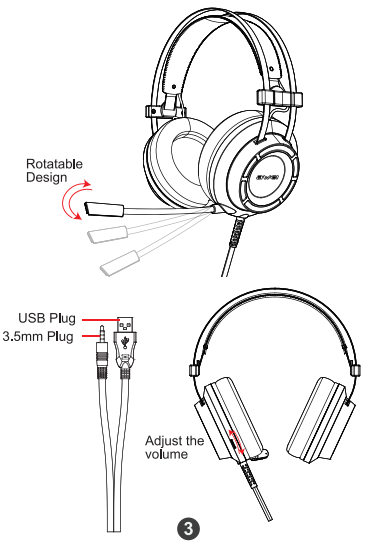

**Specifications**

- Specification
- Microphone:  $\phi 6050$  /-42 $\pm$ 3dB /2.2K/20Hz-16KHz
- Speaker:  $\phi 50$ mm 20 $\Omega$  /20Hz-20KHz
- Out Power: 20mW (1KHz 0dB)
- S/N: > 110dB
- THD: < 1% (1KHz 0dB)
- Operating temperature: -10—55°C
- Working current:  $\approx 90$ mA
- Input voltage: USB 5V
- Line length: 2100 $\pm$ 50mm
- Net weight:  $\approx 321$ g

4

**Safety And Maintenance**

- Please read suggestions below in order understand the warranty clauses and prolong the lifespan of the product.
- \*Keep the product dry, do not place in wet or humid circumstances.
- \*Avoid prolonged sun exposure and heat. High temperatures will shorten the lifespan of electronic components, damage battery and deform some plastic parts.
- \*Do not use the headphone in very low temperatures to avoid damage to PCB board.
- \*Do not attempt to take the product apart.
- \*Do not drop, force, misuse or immerse in water to avoid damage to inner electronic circuit.
- \*Do not use chemical products to clean the item.
- \*Do not scratch the surface with sharp items to avoid damaging the case and appearance.
- \*Do not charge longer than 10 hours for prolonged lifespan.

**If your product is not in working order, Please contact Roxel support team. (support@roxel.co.uk)**

5

**Guarantee and After Sales Services**

Your RGM350 is guaranteed for a period of 12months from the date of purchase  
Subject to terms listed below , the guarantee will provide the repair of, at Roxel's or its agent's discretion to replace the device, or any component thereof, ( other than batteries), which is identified as faulty or below standard or as a result of inferior workmanship or materials. Products over 30 days old from the date of purchase maybe replaced with a refurbished or repaired product.  
The conditions of guarantee are :

- \* The guarantee shall only apply to defects that occur within 12 months guarantee period
- \* Proof of purchase is required
- \*The equipment is returned to ROXEL Ltd, or its agent as instructed

This guarantee does not cover any faults or defects caused by accidents , misuse, fair wear and tear, neglect, tampering with the equipment, or any attempt adjustment or repair other than through approved agents.

This guarantee does not affect your statutory rights

6